



Zhaga book 18 LED PIR Fixture Mounted Smart Controller

DC lighting controller

TL-ZG-BPRN-MF-12-02

Product Range

Part No.	Input voltage	Operating current	Communication protocol	Communication frequency	Photosensitive range	Operating temperature
TL-ZG-BPRN-MF-12-02	DC12V	100mA (max)	Bluetooth Mesh	2405-2480MHz	10-1000Lux	-20~+60°C

Max. lauch power	Rx sensitivity	Max. communication distance	Mounting height	IP rating
8dBm	-92dB	50m(164ft)	<12m(40ft) (Open environment)	IP65

* Note: Do not use in large-scale metal areas or areas with strong electromagnetic waves nearby

Features

- PIR sensor;
- Bluetooth Mesh Wireless Self-network;
- Daylight harvesting, supports High-End Trim, Zoning, Continuous Bi-level Dimming;
- Energy monitoring with TIOSL gateway wall switch.
- Bluetooth control single route 0-10V dimming;
- Magnet reset function;(Magnet is close to the top of the module for 5 seconds to achieve reset)

Size

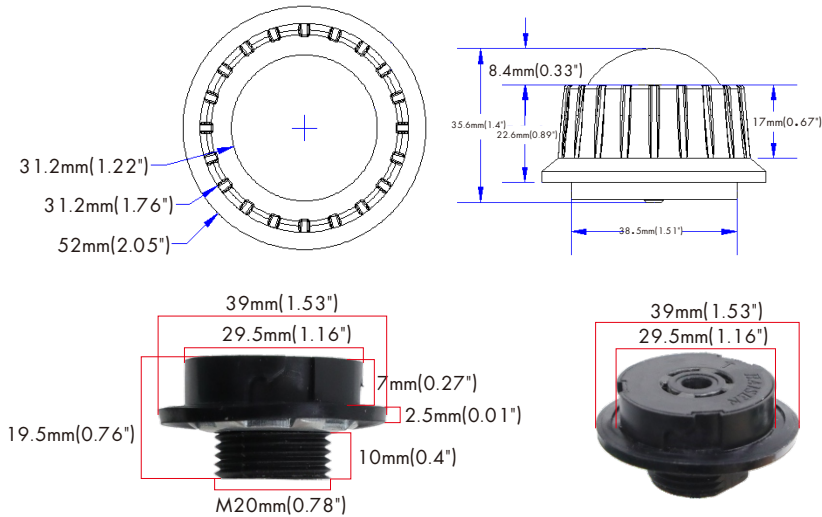

Diagram



Sensor detection angle

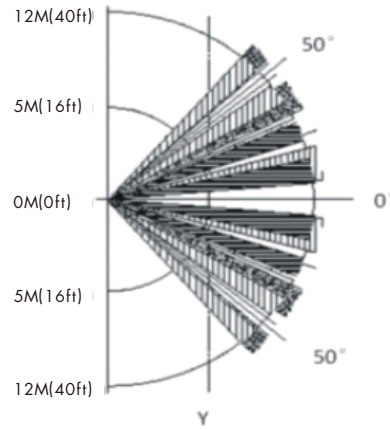
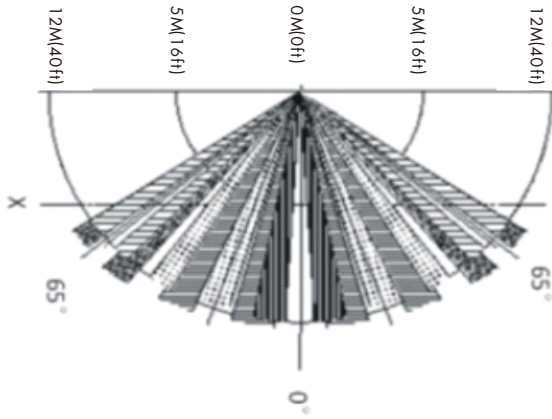

Wiring diagram

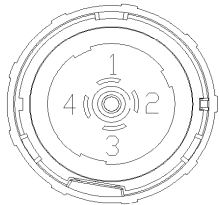

PIN1: 12V
PIN2: GND/DIM-
PIN3: NC
PIN4: DIM+



Bluetooth microwave module

Bottom view

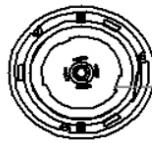

Pedestal interface



Standard base

Bottom view



base

*Hook on the big mouth

Wiring circuit diagram

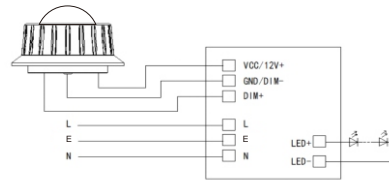

Install the Lighting Fixtures

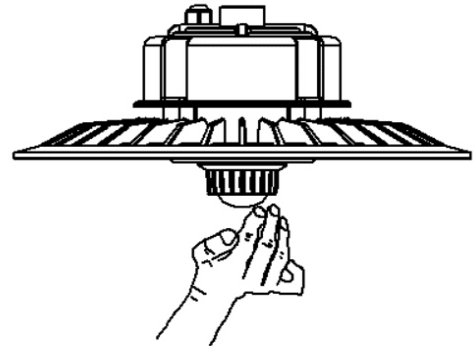

Application

LED UFO Light

LED Linear High Bay Light

LED Lighting Fixtures with Zhaga connector

Installation Precautions:

1. Before installing the Bluetooth module, first turn off the circuit breaker switch at the power supply.
2. Do not make the light fixture and place where the installation is moving before the lens

Precautions

1. We reserve the necessary text and image technical parameters correction rights
2. Without license or authorization, it is not allowed to disassemble and other people as damage, otherwise the contractual provisions guaranteed immediate failure
3. the product should not be installed in a place where the air is suddenly changed, such as air conditioning air outlet, wind direction rotation, etc.

APP "SL solutions"



SL solutions
Smart Lighting Solution

OPEN

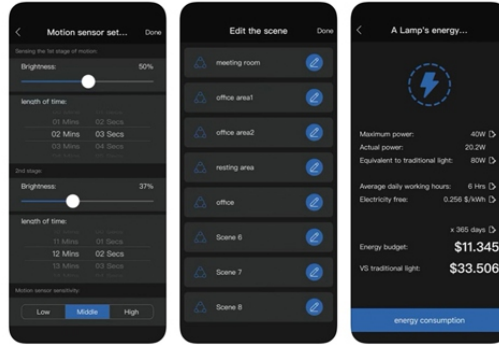

Add sensor

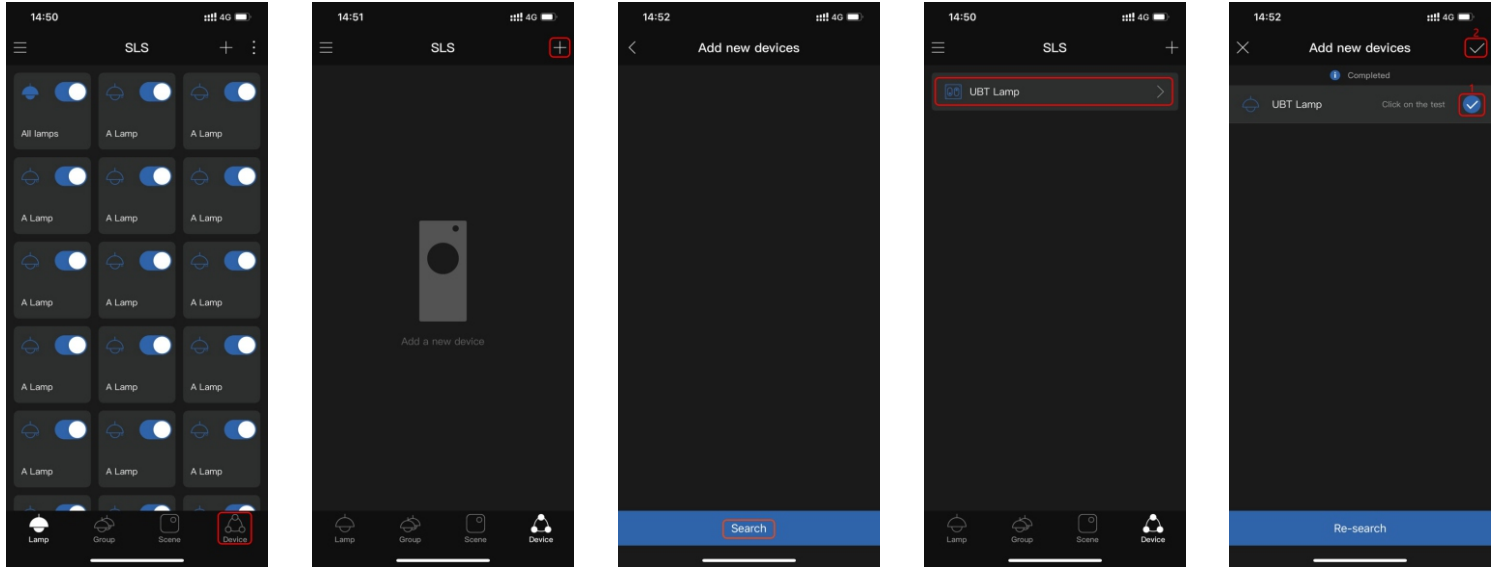

- 1-Click "device"
- 2-Click "add device"
- 3-Click "search"
- 4- Click to stop searching after searching out the device
- 5- After stopping the search, select the device that needs to be added

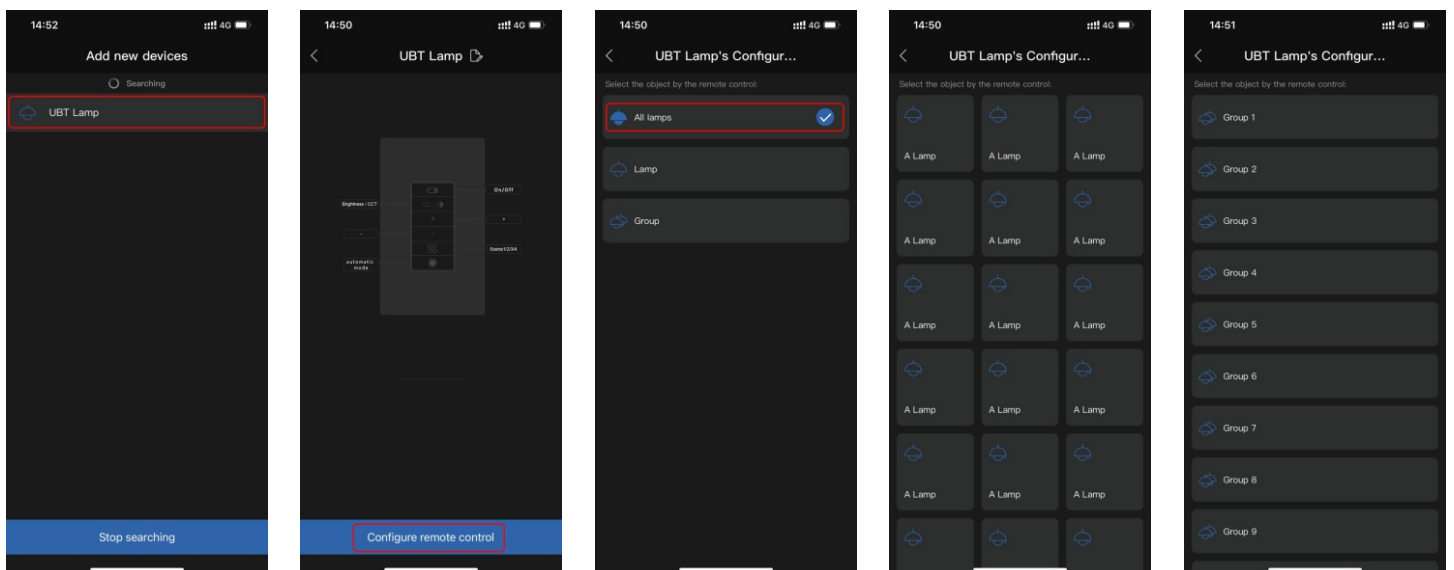

- 6- Click on the added device to enter the configuration page
- 7-Enter the binding device page
- 8-Select the device to be bound, which can support binding group, all devices, or single light
- 9-Bind a single device page,
- 10-Bind group page